

THIS DRAWING IS AN UNCONTROLLED COPY UNLESS STAMPED OTHERWISE

CONTRACTORS SHALL VERIFY ALL DIMENSIONS BEFORE ANY JOB COMMENCES. ALL SHOP DRAWINGS SHALL BE SUBMITTED TO THE SUPERINTENDENT AND MANUFACTURE SHALL NOT COMMENCE PRIOR TO THE RETURN OF UNMARKED SHOP DRAWINGS SIGNED BY THE CONSULTANT. FIGURED DIMENSIONS SHALL TAKE PRECEDENCE OVER SCALED. THIS DRAWING SHOULD BE READ IN CONJUNCTION WITH ALL RELEVANT CONTRACT SPECIFICATIONS AND DRAWING COPYRIGHT OF THIS DRAWING IS VESTED IN WARDLE.

General Notes

1. ALL DIGITAL ARTWORK FILES WILL BE PROVIDED BY ARCHITECT.
2. CONTRACTORS TO REFER TO RELATED ARCHITECTURAL SPECIFICATION SECTIONS FOR 3D MODEL INTEGRATION REQUIREMENTS.

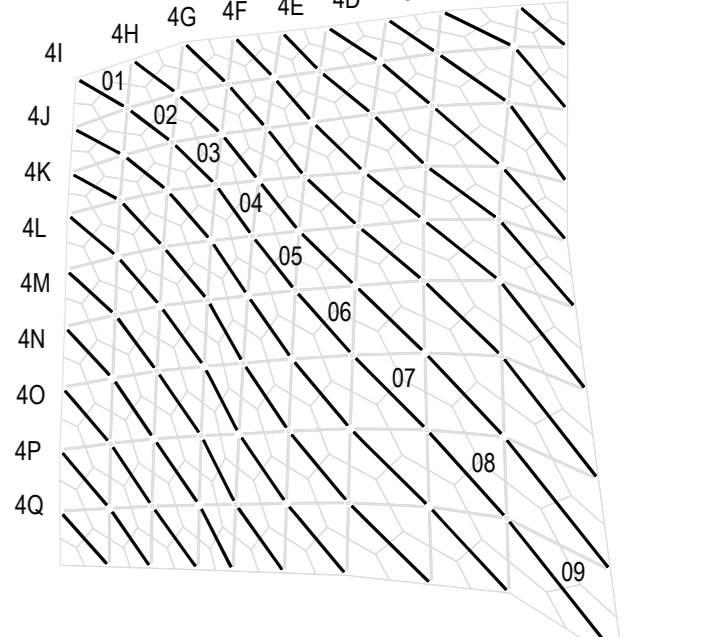

Rev	Issue	Revision Description	Amd	Date
A	SG	CONSTRUCTION ISSUE	-	06.01.14
O4	JC	100% CD - TENDER ISSUE	-	07.08.12
O3	JC	90% CD ISSUE	-	10.08.12
O2	JC	75% CD ISSUE	-	13.07.12
O1	JC	50% CD ISSUE	-	01.08.12

Rev	Issue	Revision Description	Amd	Date

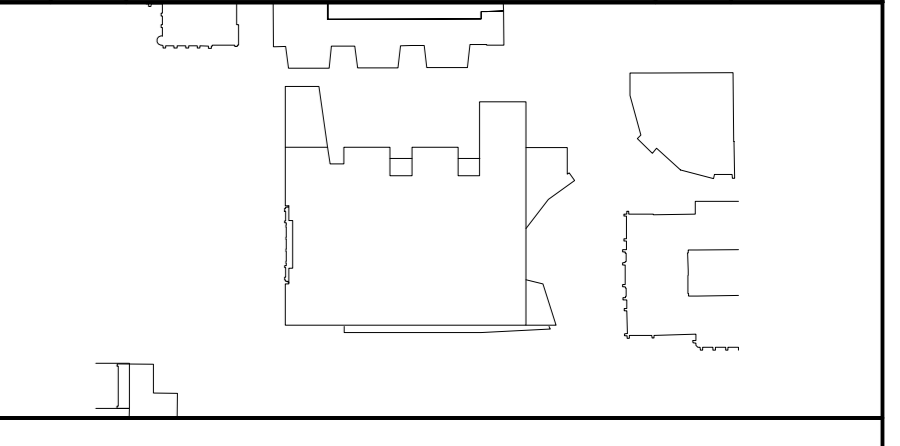

NADAAA

NADAAA
1920 Washington Street No. 2
Boston
Massachusetts
02118 USA

Telephone
+1 617 442 8332
Facsimile
+1 688 442 1417
Email
nada@nadaaa.com

John Wardle Architects

© 2011 John Wardle Architects
Level 10, 180 Russell Street, Melbourne Victoria 3000 Australia
Tel : +613 9654 8700 www.johnwardlearchitects.com

Client **University of Melbourne
Parkville Campus**

Project **Faculty of Architecture
Building and Planning**

Title **HANGING STUDIO
UNFOLDED SOFFIT**

Project No.	0913	Scale	1:20 @ A0 1:40 @ A2
Drawing No.	AR5127	Revision	A

DATE: JAN 2014 Dwn: - Cw-Ord: - Chk: -

FILENAME: ###

FOR CONSTRUCTION

01 HANGING STUDIO - UNFOLDED PANELS
SCALE 1:20